

CRS Data

Friday, December 08, 2017

**LOCATION**

**Property Address** 604 W Sullivan St  
Kingsport, TN 37660-3645

**Subdivision** Cherokee Village

**County** Sullivan County, TN

**PROPERTY SUMMARY**

**Property Type** Residential

**Land Use** Residential

**Improvement Type** Single Family

**Square Feet** 912

**GENERAL PARCEL INFORMATION**

**Parcel ID/Tax ID** 046H G 031.00

**Special Int** 000

**Alternate Parcel ID**

**Land Map** 046H

**District/Ward** 11

**2010 Census Trct/Blk** 406/3

**Assessor Roll Year** 2017

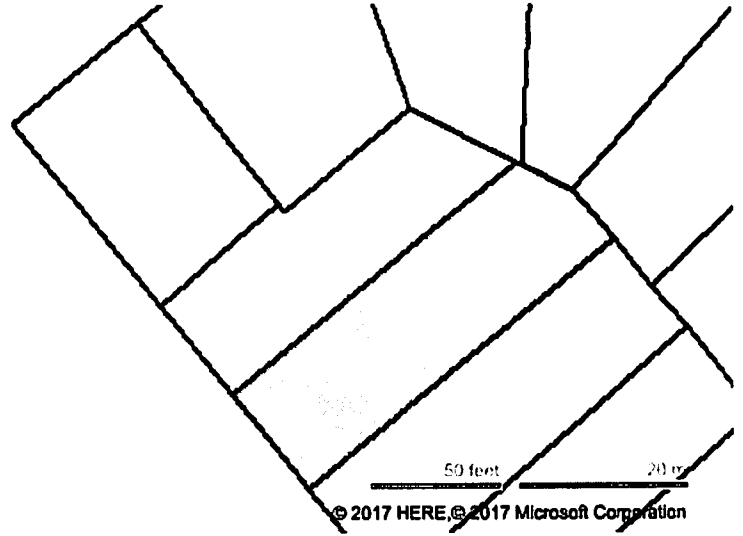

**CURRENT OWNER**

**Name** Taylor Orbin Scott Patricia

**Mailing Address** 4320 Trinity Ln  
Kingsport, TN 37664-2856

**SALES HISTORY THROUGH 11/09/2017**

Date	Amount	Buyer/Owners	Buyer/Owners 2	Instrument	No. Parcels	Book/Page Or Document#
6/23/1995	\$15,000	Taylor Orbin Scott & Patricia		Warranty Deed		1069C/65
8/12/1972		Deakins Ralph L & Jessie T				295A/192

**TAX ASSESSMENT**

Appraisal	Amount	Assessment	Amount	Jurisdiction	Rate
<b>Appraisal Year</b>	2017	<b>Assessment Year</b>	2017	<b>Kingsport</b>	1.975
<b>Appraised Land</b>	\$11,600	<b>Assessed Land</b>		<b>Sullivan</b>	2.55
<b>Appraised Improvements</b>	\$26,100	<b>Assessed Improvements</b>			
<b>Total Tax Appraisal</b>	\$37,700	<b>Total Assessment</b>	\$9,425		
		<b>Exempt Amount</b>			
		<b>Exempt Reason</b>			

**TAXES**

Tax Year	City Taxes	County Taxes	Total Taxes
2017	\$186.14	\$240.34	\$426.48
2016	\$249.95	\$310.98	\$560.93
2014	\$249.95	\$278.38	\$528.33
2013	\$234.26	\$278.38	\$512.64

**MORTGAGE HISTORY**

Date	Loan Amount	Borrower	Lender	Book/Page or Document#	Assignments/ Releases
12/15/2003	\$57,570	Taylor Orbin S Taylor Patricia S	Bank Of Tennessee	2053C/182	
06/26/1995	\$41,000	Taylor Orbin	First American	1069C/68	

PROPERTY CHARACTERISTICS: BUILDING

Building # 1

Type	Single Family	Condition	Average	Units	
Year Built	1943	Effective Year	1962	Stories	1
BRs		Baths	F H	Rooms	
Total Sq. Ft.	912				
Building Square Feet (Living Space)			Building Square Feet (Other)		

Base 912

- CONSTRUCTION

Quality	Below Average	Roof Framing	Gable/Hip
Shape	Rectangular Design	Roof Cover Deck	Composition Shingle
Partitions		Cabinet Millwork	Average
Common Wall		Floor Finish	Carpet Combination
Foundation	Continuous Footing	Interior Finish	Drywall
Floor System	Slab On Grade	Air Conditioning	
Exterior Wall	Common Brick	Heat Type	Heating W/ Ducts
Structural Framing		Bathroom Tile	
Fireplace		Plumbing Fixtures	3

- OTHER

Occupancy	Occupied	Building Data Source
-----------	----------	----------------------

PROPERTY CHARACTERISTICS: EXTRA FEATURES

Feature	Size or Description	Year Built	Condition
Patio	5X20	1941	AVERAGE
Canopy	5X6	1941	AVERAGE

PROPERTY CHARACTERISTICS: LOT

Land Use	Residential	Lot Dimensions	45 X 153.91 IRR
Block/Lot	1/10Y	Lot Square Feet	
Latitude/Longitude	36.555614°/-82.564218°	Acreage	

PROPERTY CHARACTERISTICS: UTILITIES/AREA

Gas Source	Public - Natural Gas	Road Type	Paved
Electric Source	Public	Topography	Level
Water Source	Public	District Trend	Stable
Sewer Source	Public	Special School District 1	
Zoning Code		Special School District 2	
Owner Type			

LEGAL DESCRIPTION

Subdivision	Cherokee Village	Plat Book/Page	2/99
Block/Lot	1/10Y	District/Ward	11
Description			

FLOOD ZONE INFORMATION

Zone Code	Flood Risk	BFE	Description	FIRM Panel ID	FIRM Panel Eff. Date
AE	High		Areas subject to inundation by the 1-percent-annual-chance flood event determined by detailed methods. Base Flood Elevations (BFEs) are shown. Mandatory flood insurance purchase requirements and floodplain management standards apply.	47163C0040D	09/29/2006