



Wednesday, May 16, 2018

LOCATION

<b>Property Address</b>	1909 Birchwood Rd Kingsport, TN 37660-5056
<b>Subdivision</b>	Huntington Hills Sec 1
<b>County</b>	Sullivan County, TN

PROPERTY SUMMARY

<b>Property Type</b>	Residential
<b>Land Use</b>	Residential
<b>Improvement Type</b>	Single Family
<b>Square Feet</b>	2471

GENERAL PARCEL INFORMATION

<b>Parcel ID/Tax ID</b>	060G C 010.00
<b>Special Int</b>	000
<b>Alternate Parcel ID</b>	
<b>Land Map</b>	060G
<b>District/Ward</b>	12
<b>2010 Census Trct/Blk</b>	415/2
<b>Assessor Roll Year</b>	2017

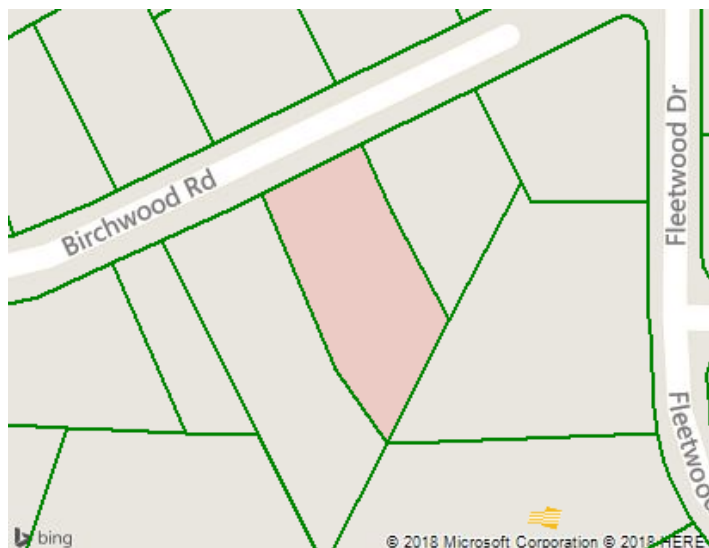

CURRENT OWNER

<b>Name</b>	Allgood Jack Ruby Lois
<b>Mailing Address</b>	1909 Birchwood Rd Kingsport, TN 37660-5056

SALES HISTORY THROUGH 04/02/2018

Date	Amount	Buyer/Owners	Buyer/Owners 2	Instrument	No. Parcels	Book/Page Or Document#
8/30/1990	\$116,000	Allgood Jack & Ruby Lois		Warranty Deed		740C/808
9/26/1978						183C/122
4/19/1978						162C/607
1/1/1978	\$87,950			Warranty Deed		183C/122
11/22/1967					34	298A/694

TAX ASSESSMENT

Appraisal	Amount	Assessment	Amount	Jurisdiction	Rate
<b>Appraisal Year</b>	2017	<b>Assessment Year</b>	2017	<b>Kingsport</b>	1.975
<b>Appraised Land</b>	\$25,800	<b>Assessed Land</b>		<b>Sullivan</b>	2.55
<b>Appraised Improvements</b>	\$188,500	<b>Assessed Improvements</b>			
<b>Total Tax Appraisal</b>	\$214,300	<b>Total Assessment</b>	\$53,575		
		<b>Exempt Amount</b>			
		<b>Exempt Reason</b>			

TAXES

Tax Year	City Taxes	County Taxes	Total Taxes
2017	\$1,058.11	\$1,366.16	\$2,424.27
2016	\$1,051.56	\$1,308.30	\$2,359.86

2014	\$1,051.56	\$1,171.14	\$2,222.70
2013	\$985.52	\$1,171.14	\$2,156.66

## MORTGAGE HISTORY

No mortgages were found for this parcel.

## PROPERTY CHARACTERISTICS: BUILDING

## Building # 1

<b>Type</b>	Single Family	<b>Condition</b>	Average	<b>Units</b>	
<b>Year Built</b>	1978	<b>Effective Year</b>	1992	<b>Stories</b>	1
<b>BRs</b>		<b>Baths</b>	F H	<b>Rooms</b>	

**Total Sq. Ft.** 2,471

<b>Building Square Feet (Living Space)</b>	<b>Building Square Feet (Other)</b>
Base 2471	Enclosed Porch Finished 176
	Enclosed Porch Finished 336
	Garage Finished 576
	Open Porch Finished 24

## - CONSTRUCTION

<b>Quality</b>	Average	<b>Roof Framing</b>	Gable/Hip
<b>Shape</b>	Rectangular Design	<b>Roof Cover Deck</b>	Composition Shingle
<b>Partitions</b>		<b>Cabinet Millwork</b>	Average
<b>Common Wall</b>		<b>Floor Finish</b>	Carpet Combination
<b>Foundation</b>	Continuous Footing	<b>Interior Finish</b>	Drywall
<b>Floor System</b>	Wood W/ Sub Floor	<b>Air Conditioning</b>	Cooling Split
<b>Exterior Wall</b>	Common Brick	<b>Heat Type</b>	Heat Split
<b>Structural Framing</b>		<b>Bathroom Tile</b>	
<b>Fireplace</b>	Y	<b>Plumbing Fixtures</b>	8

## - OTHER

<b>Occupancy</b>	Occupied	<b>Building Data Source</b>	Owner
------------------	----------	-----------------------------	-------

## PROPERTY CHARACTERISTICS: EXTRA FEATURES

<b>Feature</b>	<b>Size or Description</b>	<b>Year Built</b>	<b>Condition</b>
Wood Deck	176	1978	AVERAGE
Wood Deck	4X6	1978	AVERAGE

## PROPERTY CHARACTERISTICS: LOT

<b>Land Use</b>	Residential	<b>Lot Dimensions</b>	100X188.05 IRR
<b>Block/Lot</b>	H/3	<b>Lot Square Feet</b>	
<b>Latitude/Longitude</b>	36.536224°/-82.592521°	<b>Acreage</b>	

## PROPERTY CHARACTERISTICS: UTILITIES/AREA

<b>Gas Source</b>		<b>Road Type</b>	Paved
<b>Electric Source</b>	Public	<b>Topography</b>	Rolling
<b>Water Source</b>	Public	<b>District Trend</b>	Stable
<b>Sewer Source</b>	Public	<b>Special School District 1</b>	
<b>Zoning Code</b>	R 1B	<b>Special School District 2</b>	
<b>Owner Type</b>			

LEGAL DESCRIPTION

<b>Subdivision</b>	Huntington Hills Sec 1	<b>Plat Book/Page</b>	10/59
<b>Block/Lot</b>	H/3	<b>District/Ward</b>	12
<b>Description</b>			

FLOOD ZONE INFORMATION

<b>Zone Code</b>	<b>Flood Risk</b>	<b>BFE</b>	<b>Description</b>	<b>FIRM Panel ID</b>	<b>FIRM Panel Eff. Date</b>
X	Minimal		Area of minimal flood hazard, usually depicted on FIRMs as above the 500-year flood level.	47163C0040D	09/29/2006